

Pneumatic vacuum ball valve

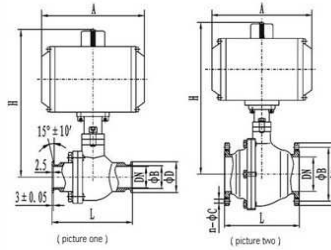

These pneumatic vacuum ball valve is applicable for the medium flow of connecting or cutting off the pipelines in the vacuum system.

This valve uses compressed air as the dynamics. It changes the gas circuit direction through the control of pneumatic components. It pushes forward the air cylinder to make the ball valve have start-stop motions. The straightway valve relies on spherical sealing. Therefore it can be used in both the vacuum and low pressure conditions. It can also be installed in random position. It has Double-acting and Single-acting (Spring return) air cylinder with optional Singal feedback device and electric valves servo.

Technical specifications:

Operation range (m. BAR)	Quick release flange (KF) $2 \times 10^3 \sim 1.3 \times 10^{-7}$ Loose flange $16 \times 10^3 \sim 1.3 \times 10^{-7}$
Valve Leakage Rate(m.Bar.L/S)	$\leq 1.3 \times 10^{-7}$
Time for opening and closing the valve (S)	DN \leq 32 20 ; DN \geq 40 30
Medium temperature (°C)	Standard manufacture : -30~+150 Special designation : -30~+240
Flange Standard	GB4982 ; GB/T6070
Installation location	Random
Rated voltage	Standard manufacture : AC220V/50Hz Switch type Special designation : AC380V ; DC24V Switch type 4~20mA DC Adjustable
Signal Feedback	Standard manufacture: Without passive contactor Special designation : 4~20mA DC Adjustable
Air Cylinder	Standard manufacture: Double-acting Special designation: Single-acting(Spring return) N/o or N/c

flange(KF)connection and outline dimension (GB4982)

Model	Nominal diameter (DN)	D(mm)	B(mm)	H(mm)	L(mm)	A(mm)
PVBV-16/KF	16	30	17.2	154	100	140
PVBV-16/KF	25	40	26.2	175	114	164
PVBV-40/KF	40	55	41.2	247	168	210
PVBV-50/KF	50	75	52.2	282	175	247

Loose flange connection and outline dimension GB/T6070)

Model	Nominal Diameter(DN)	ΦD	ΦB	H	L	A	n-ΦC
PVBV-16	16	60	45	154	100	164	4-6.5
PVBV -25	25	70	55	175	114		
PVBV -32	32	90	70	220	140		
PVBV -40	40	100	80	247	165		4-9
PVBV -50	50	110	90	282	175		
PVBV -63	63	130	110	320	186	247	
PVBV -80	80	145	125	345	198		8-9
PVBV -100	100	165	145	378	220		
PVBV -125	125	200	175	458	266	432	8-11
PVBV -150	150	225	200	523	296		

ph: +91-080-23327059 Mob: +91-9886726920,

e mail: support@uniquevacuum.co.in