

## High-vacuum butterfly valve- MANUAL OPERATION

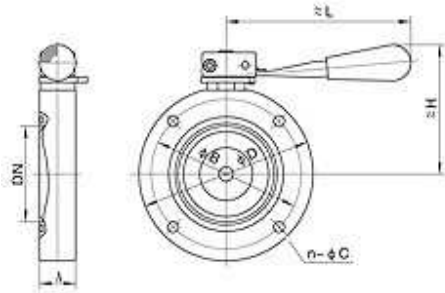

This high-vacuum butterfly valve is applicable for connecting or cutting off the airflow in the vacuum tubes. The valve plate adopts the clamping structure. It tightly grips the valve plate seal ring that gets better seal.

The open/close of valve has lock function. The applicable active media of this valve are air, non-corrosive gas.

### Technical specification:

|                                |   |
|--------------------------------|---|
| Scope (m.Bar)                  | $10^3 \sim 1.3 \times 10^{-7}$                                    |
| Valve Leakage Rate (m.Bar.L/S) | $\leq 1.3 \times 10^{-8}$   |
| Medium temperature (°C)        | -25~+80 (Sealing Material NBR)<br>-30~+150 (Sealing Material FPM) |
| Pressure of air supply (MPa)   | 0.4~0.8   |
| Flange Standard                | JB919   |
| Installation location          | Random  |

### Connection and Dimensions :

| Model    | Nominal Diameter (DN) | ΦD  | ΦB  | H   | A  | L   | n-ΦC  |
|----------|-----------------------|-----|-----|-----|----|-----|-------|
| MBV-25   | 25                    | 70  | 55  | 65  | 22 | 105 | 4-Φ7  |
| MBV-32   | 32                    | 78  | 64  | 70  | 22 | 105 | 4-Φ7  |
| MBV -40  | 40                    | 85  | 70  | 75  | 22 | 116 | 4-Φ7  |
| MBV -50  | 50                    | 110 | 90  | 90  | 22 | 116 | 4-Φ9  |
| MBV -63  | 63                    | 130 | 110 | 100 | 26 | 132 | 4-Φ9  |
| MBV -80  | 80                    | 145 | 130 | 110 | 30 | 154 | 4-Φ9  |
| MBV -100 | 100                   | 170 | 145 | 120 | 30 | 154 | 4-Φ12 |
| MBV -125 | 125                   | 195 | 170 | 140 | 35 | 197 | 4-Φ12 |
| MBV -150 | 150                   | 220 | 195 | 155 | 35 | 197 | 8-Φ12 |
| MBV -200 | 200                   | 275 | 250 | 190 | 40 | 242 | 8-Φ12 |
| MBV -250 | 250                   | 330 | 300 | 225 | 45 | 330 | 8-Φ12 |
| MBV -300 | 300                   | 380 | 350 | 245 | 55 | 330 | 8-Φ14 |
| MBV -400 | 400                   | 500 | 465 | 409 | 60 | 420 | 8-Φ18 |

ph: +91-080-23327059 Mob: +91-9886726920,  
e mail: [support@uniquevacuum.co.in](mailto:support@uniquevacuum.co.in)